



## SwissED 2018

Date:

**3th of September**

Location:

**Lake Side**

Bellerivestrasse 170



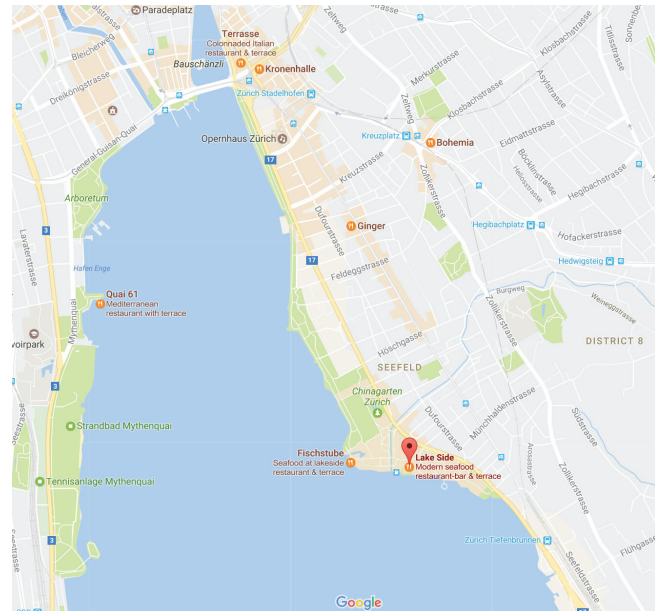

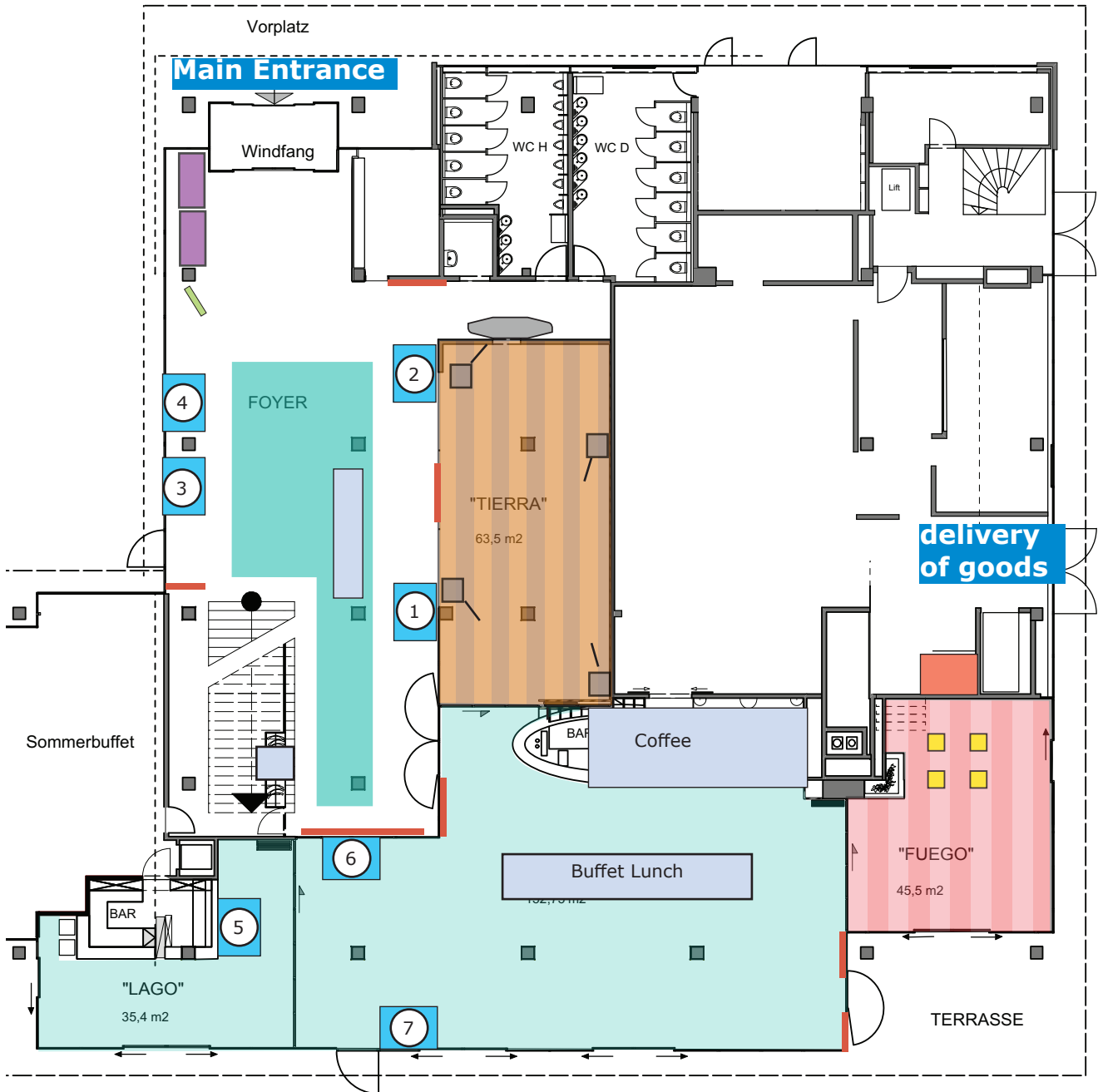

8008 Zürich











Entrance Level



Rooms & areas

-  Lunch area / coffee area
-  Apero area
-  Aqua + Viento (Keynote)
-  World Café - Track 1
-  Business corner
-  Coffee machine self service

Objects

-  Welcome desks
-  Workplace (6 desks with 12 chairs)
-  Buffet / Bar
-  Space reserved for rollups of silver sponsors
-  Desk for sponsor leaflets
-  Goods lift
-  Wardrobe
-  Infoscreen

First Floor

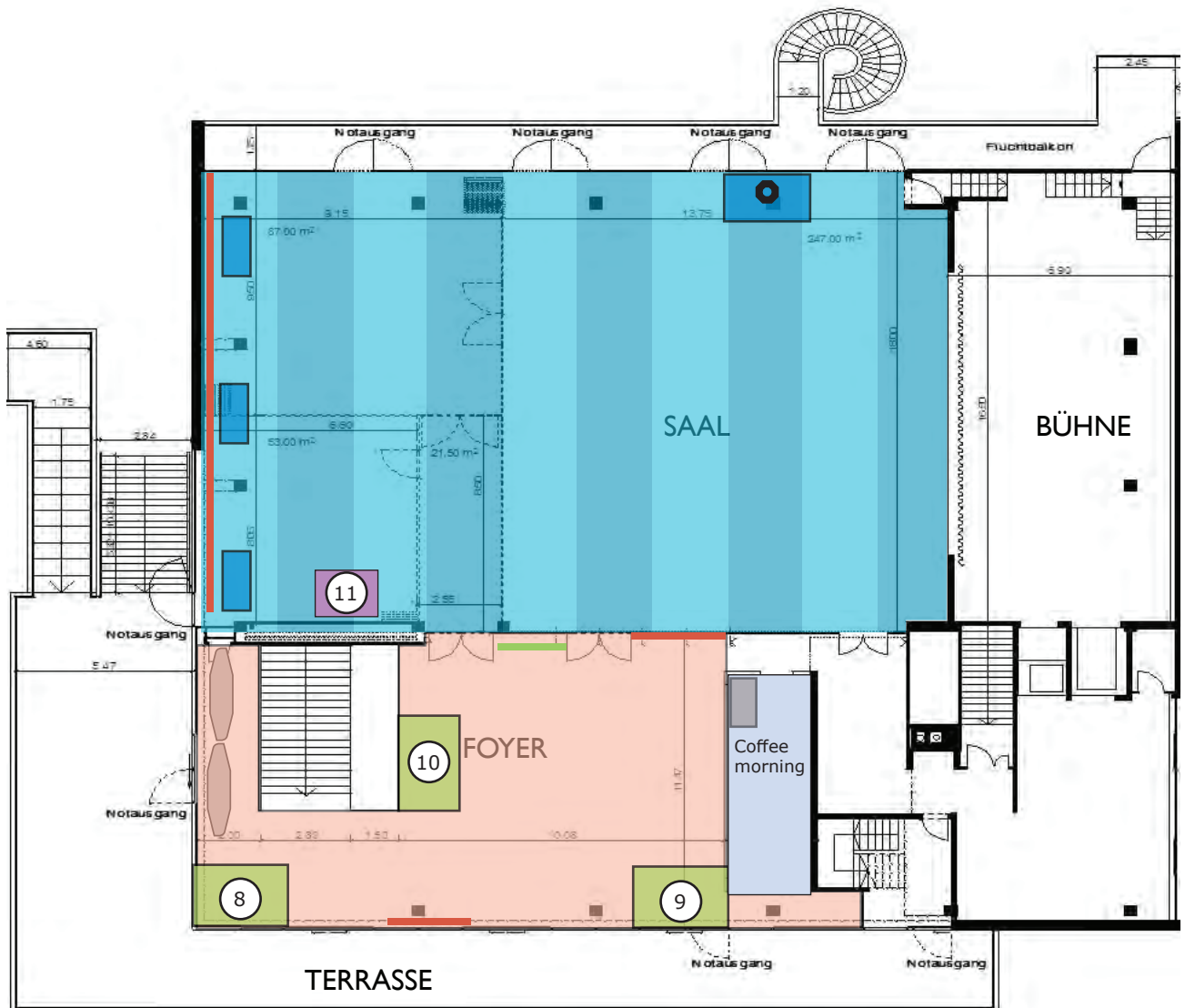

Layout Stands for Sponsors

- 1** SE-Training GmbH
- 2** PSE
- 3** Contat Software
- 4** NoMagic
- 5** MID
- 6** ALTEN
- 7** Rheinmetall
- 8** 3DS Dassault Systemes
- 9** Siemens
- 10** HP
- 11** Incose
-  Microphon and Audio

- 1** Oose
- 2** Frikart
- 3** PPI
- 4** Evocean
- 5** LieberLieber
- 6**
- 7**
- 8**
- 9**

